



CLIVEDEN

*Celebrate with us this*  
**CHRISTMAS**  
**AND NEW YEAR**



*Festive Group Brochure*



# PRIVATE FESTIVE DINING

At Cliveden House

Celebrate the festive season with family and friends in one of our elegant and opulent private dining rooms.

## LUNCH

£105 per person

Laurent-Perrier  
champagne on arrival

### STARTER

Delica Pumpkin  
*butternut hummus, toasted pine  
nuts, pine tree oil*

Smoked Salmon  
*radish, cucumber, yoghurt*

Venison Tartare  
*blackberry mustard, walnut bread*

### MAIN COURSE

Jerusalem Artichoke Risotto  
*vanilla, redcurrants*

Seared Bass  
*mussel chowder, saffron sauce*

Norfolk Bronze Turkey  
*sage and apricot stuffing, crispy roast potatoes,  
carrots, parsnips, sprouts*

### DESSERT

Cliveden Cheesecake  
*blackberry, lemon verbena*

Apple Tarte Tatin  
*salted caramel, vanilla ice cream*

Christmas Pudding  
*brandy ice cream*

Tea, Coffee and Mince Pies

## DINNER

£120 per person

Laurent-Perrier  
champagne on arrival

### STARTER

Truffle Risotto

Loch Duart Salmon Tatare  
*redcurrant, avocado*

Duck Terrine  
*spiced orange jam, rye*

### MAIN COURSE

Parsley Gnocchi  
*butternut, goat's curd, sage*

Seared Bass  
*mussel chowder, saffron*

Norfolk Bronze Turkey  
*sage and apricot stuffing, crispy roast potatoes,  
carrots, parsnips, sprouts*

### DESSERT

Dark Chocolate Tart  
*pine tree ice cream*

Cranberry Mille-Feuille  
*burnt custard, star anis*

Cliveden Christmas Pudding  
*brandy ice cream*

Seasonal Selection of Five Cheeses  
*grapes, celery, walnut & raisin bread, crackers*  
(add as supplement £10)

Tea, Coffee and Mince Pies

Applicable to groups of 10 guests or more. Available in one of our 5 private dining rooms only.  
Suitable for parties of 10-60. Room hire starts from £400 and parties are asked to pre-order.  
The rooms have beautiful festive decorations and crackers will be included.

Weekend supplement of £20 per person on Friday, Saturday and Sunday for both lunch and dinner.

Available from 24th November until 22nd December 2023.



THE FRENCH  
DINING ROOM





# THE FRENCH DINING ROOM

The French Dining Room is one of the most exquisite and dazzling rooms in the House, filled with light and beautiful views of the river and Berkshire countryside. On a visit to Paris in 1897 William Waldorf Astor was shown the intricate gilded panelling in Madame de Pompadour's 18th century dining room at the Château d'Asnières. Realising the proportions exactly matched those of the dining room at Cliveden he bought the panelling, table and chairs, then had the entire room reconstructed in his home. Seating up to sixty guests, this Rococo masterpiece provides an incomparable setting for a romantic wedding breakfast, impressive lunch or sumptuous dinner.

### CAPACITIES

Boardroom	28	Reception	80
Dining	60	Theatre	80
U-Shaped	26	Cabaret	24

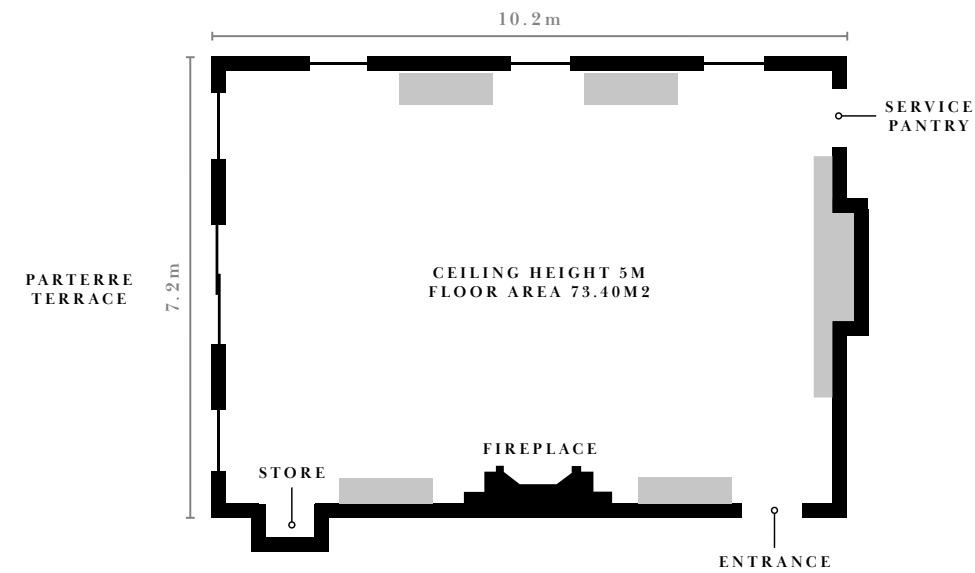



## THE CELLAR DINING ROOM

A unique underground venue with a difference. Once Lord Astor's private wine cellar, the Cellar Dining Room has been beautifully restored and is perfect for a more intimate, informal setting. It has brick walls, mighty pillars and a vaulted ceiling, creating an unusual and atmospheric dining room for smaller parties and private gatherings. It's also perfect for hosting wine tastings.

### CAPACITIES

12 on one rectangle table

Height 3.5m

Width 5.2m

Length 5m





# BOUDOIR AND TOTE ROOM

The Boudoir and Tote Room are located on the ground floor of the House, and were the respective interconnecting sitting rooms of Lady and Lord Astor. As such they follow distinct but complimentary styles – the Boudoir is romantically decorated in blue drapes with large windows overlooking the Parterre and lawn, and the Tote is a smaller room with comfortable furniture around a cosy fireplace. Both rooms are available for private functions, and are perfect for meetings, dining, afternoon tea or private events.

CAPACITIES BOUDOIR		CAPACITIES TOTE ROOM	
Boardroom	14	Boardroom	6
Dining	24	Dining	10
U-Shaped	15	U-Shaped	6
Reception	20	Reception	10
Theatre	30	Theatre	10

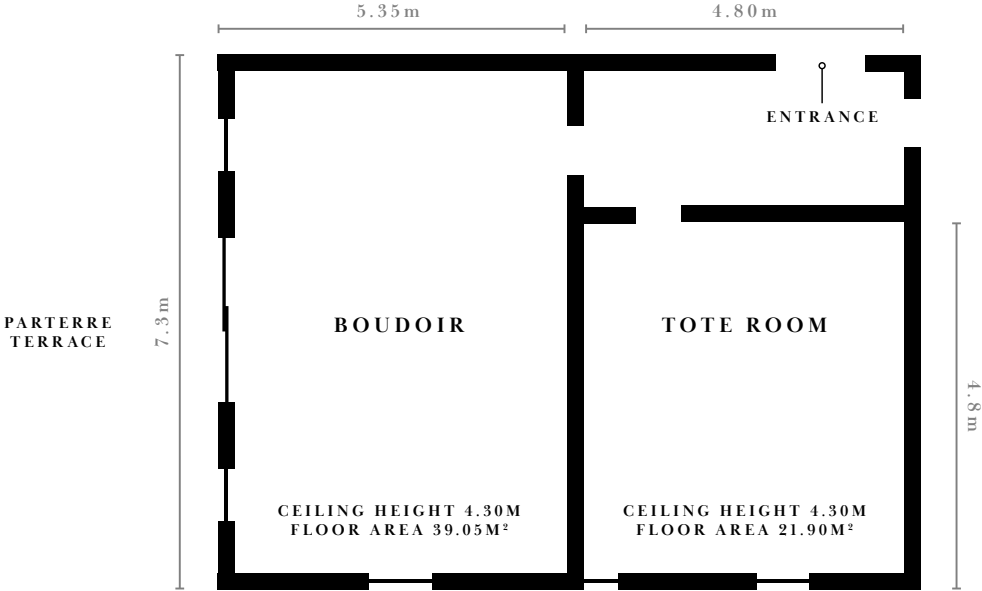



# WALDO'S

Set in the House's former servants' quarters, Waldo's comprises two interconnecting modern function spaces for meetings and private dining.

With natural daylight, air-conditioning and complimentary Wi-Fi, the beautiful rooms feature a fireplace and many paintings highlighting Cliveden's heritage and history.

## CAPACITIES

### FRONT ROOM

Width	5.4m
Length	7.15m
Boardroom	14
U-Shape	14
Theatre	24
Cabaret with AV	16
Dining (round tables)	20
Dining (oval tables)	20
Drinks Reception	20
Relaxed Informal	18

### BACK ROOM

Width	5.3m
Length	7.2m
Boardroom	22
U-Shape	16
Theatre	48
Cabaret with AV	18
Dining (round tables)	30
Dining (oval tables)	20
Drinks Reception	40
Relaxed Informal	18







THE SCREENING ROOM

The state-of-the-art Screening Room is ideal for impressive presentations or festive movie nights. Interconnecting perfectly with Waldo's, the room is fitted with the latest technology combining efficiency and ease of use with the elegance and unparalleled luxury that are the hotel's trademarks.

CAPACITIES	
Width	7.2m
Length	7.7m
Boardroom	18
U-Shape	16
Theatre	60
Cabaret with AV	24
Dining (round tables)	40
Dining (oval tables)	22
Drinks Reception	50
Relaxed Informal	18





CLIVEDEN

ENQUIRE NOW

Taplow | Berkshire | SL6 0JF

TEL 01628 668561

[special.events@clivedenhouse.co.uk](mailto:special.events@clivedenhouse.co.uk)    [www.clivedenhouse.co.uk](http://www.clivedenhouse.co.uk)

